

Select The Right Terminal

Heat Shrink Terminals and Connectors See Page 6 & 7

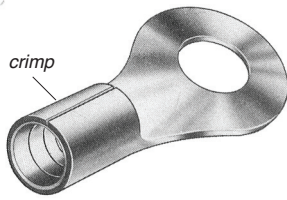

BUTTED SEAM BARREL NON-INSULATED

Electro-tin plated copper terminal
Can be crimped or soldered.
Operating Temp -40°F (-40°C) to 167°F (75°C)

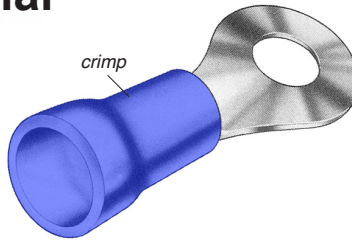

BUTTED SEAM BARREL FLARED VINYL INSULATION

Electro-tin plated copper terminal with flared vinyl insulation. Flare overlaps wire insulation providing support for terminated wire.
Operating Temp -40°F (-40°C) to 167°F (75°C)

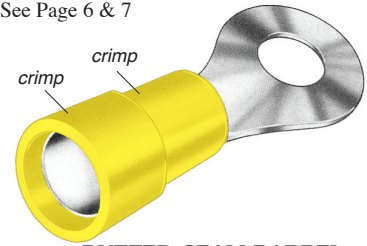

BUTTED SEAM BARREL NYLON INSULATION METAL SUPPORT SLEEVE

Electro-tin plated copper terminal with metal support sleeve. Crimp on terminal barrel and over brass sleeve.
Operating Temp -40°F (-40°C) to 167°F (75°C)

Rings

Most Commonly Used Style of Terminal - Not For Use Where Frequent Removal Is Necessary

VINYL INSULATED

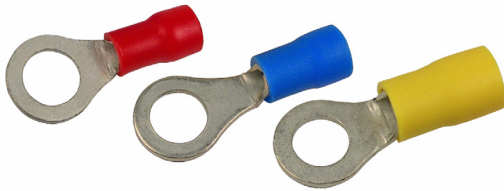

| Stud Size | Red 22-16 AWG | | | | Blue 16-14 AWG | | | | Yellow 12-10 AWG | | | |
|-----------|---------------|------|--------|-----|----------------|------|--------|-----|------------------|-----|--------|-----|
| | Part # | Qty | Part # | Qty | Part # | Qty | Part # | Qty | Part # | Qty | Part # | Qty |
| #6 | 1703A | 1000 | — | — | 1803A | 1000 | — | — | 1903A | 500 | — | — |
| #6 | 1703C | 100 | 1703PT | 100 | 1803C | 100 | 1803PT | 100 | 1903G | 100 | 1903PT | 50 |
| #6 | 1703D | 14 | 1703KT | 20 | 1803D | 14 | 1803KT | 20 | 1903C | 50 | 1903KT | 13 |
| #6 | 1703M | 5 | 1703QT | 5 | 1803M | 5 | 1803QT | 5 | 1903M | 3 | 1903QT | 3 |
| #8 | 1704A | 1000 | — | — | 1804A | 1000 | — | — | 1904A | 500 | — | — |
| #8 | 1704C | 100 | 1704PT | 100 | 1804C | 100 | 1804PT | 100 | 1904G | 100 | — | — |
| #8 | 1704D | 14 | 1704KT | 20 | 1804D | 14 | 1804KT | 20 | 1904C | 50 | 1904PT | 50 |
| #8 | 1704M | 5 | 1704QT | 5 | 1804M | 5 | 1804QT | 5 | 1904D | 9 | 1904KT | 14 |
| #8 | — | — | — | — | — | — | — | — | 1904M | 3 | 1904QT | 3 |
| #10 | 1705A | 1000 | — | — | 1805A | 1000 | — | — | 1905A | 500 | — | — |
| #10 | 1705C | 100 | 1705PT | 100 | 1805C | 100 | 1805PT | 100 | 1905G | 100 | — | — |
| #10 | 1705H | 20 | 1705KT | 20 | 1805H | 20 | 1805KT | 20 | 1905C | 50 | 1905PT | 50 |
| #10 | 1705D | 14 | — | — | 1805D | 14 | — | — | 1905H | 14 | 1905KT | 14 |
| #10 | 1705M | 5 | 1705QT | 5 | 1805M | 5 | 1805QT | 5 | 1905D | 9 | — | — |
| #10 | — | — | — | — | — | — | — | — | 1905M | 3 | 1905QT | 3 |
| 1/4" | 1706A | 1000 | — | — | 1806A | 1000 | — | — | 1906A | 500 | — | — |
| 1/4" | 1706C | 50 | 1706PT | 50 | 1806C | 50 | 1806PT | 50 | 1906G | 100 | — | — |
| 1/4" | 1706D | 9 | 1706KT | 14 | 1806C | 50 | 1806PT | 50 | 1906C | 25 | 1906PT | 25 |
| 1/4" | 1706M | 3 | 1706QT | 3 | 1806H | 14 | 1806KT | 14 | 1906H | 12 | 1906KT | 12 |
| 1/4" | — | — | — | — | 1806D | 9 | — | — | 1906D | 7 | — | — |
| 1/4" | — | — | — | — | 1806M | 3 | 1806QT | 3 | 1906M | 3 | 1906QT | 3 |
| 5/16" | 1708A | 1000 | — | — | 1808A | 1000 | — | — | 1908A | 500 | — | — |
| 5/16" | 1708C | 50 | 1708PT | 50 | 1808G | 100 | — | — | 1908G | 100 | — | — |
| 5/16" | 1708D | 9 | 1708KT | 12 | 1808C | 50 | 1808PT | 50 | 1908C | 25 | 1908PT | 25 |
| 5/16" | 1708M | 3 | 1708QT | 3 | 1808D | 9 | 1808KT | 12 | 1908D | 7 | 1908KT | 11 |
| 5/16" | — | — | — | — | 1808M | 3 | 1808QT | 3 | 1908M | 2 | 1908QT | 2 |
| 3/8" | 1709A | 1000 | — | — | 1809A | 1000 | — | — | 1909A | 500 | — | — |
| 3/8" | 1709C | 50 | 1709PT | 50 | 1809G | 100 | — | — | 1909G | 100 | — | — |
| 3/8" | 1709D | 8 | 1709KT | 10 | 1809C | 50 | 1809PT | 50 | 1909C | 25 | 1909PT | 25 |
| 3/8" | 1709M | 2 | 1709QT | 2 | 1809D | 8 | 1809KT | 10 | 1909H | 10 | 1909KT | 10 |
| 3/8" | — | — | — | — | 1809M | 2 | 1809QT | 2 | 1909D | 6 | — | — |
| 3/8" | — | — | — | — | — | — | — | — | 1909M | 2 | 1909QT | 2 |
| 1/2" | — | — | — | — | — | — | — | — | 1913A | 500 | — | — |
| 1/2" | — | — | — | — | — | — | — | — | 1913G | 100 | — | — |
| 1/2" | — | — | — | — | — | — | — | — | 1913C | 25 | 1913PT | 25 |
| 1/2" | — | — | — | — | — | — | — | — | 1913D | 3 | 1913KT | 5 |
| 1/2" | — | — | — | — | — | — | — | — | 1913M | 1 | 1913QT | 1 |

NON-INSULATED



| | | | | | | | | | | | | |
|-------|-------|------|-------|-----|-------|------|-------|-----|-------|-----|-------|----|
| #6 | 2303A | 1000 | 2303C | 100 | 2403A | 1000 | 2403C | 100 | 2503A | 500 | 2503C | 50 |
| #8 | 2304A | 1000 | 2304C | 100 | 2404A | 1000 | 2404C | 100 | 2504A | 500 | 2504C | 50 |
| #10 | 2305A | 1000 | 2305C | 100 | 2405A | 1000 | 2405C | 100 | 2505A | 500 | 2505C | 50 |
| 1/4" | 2306A | 1000 | 2306C | 100 | 2406A | 1000 | 2406C | 100 | 2506A | 500 | 2506C | 50 |
| 5/16" | 2308A | 1000 | 2308C | 100 | 2408A | 1000 | 2408C | 100 | 2508A | 500 | 2508C | 50 |
| 3/8" | 2309A | 1000 | 2309C | 100 | 2409A | 1000 | 2409C | 100 | 2509A | 500 | 2509C | 50 |
| 1/2" | — | — | — | — | — | — | — | — | 2513A | 500 | 2513C | 50 |

NYLON INSULATED WITH METAL SLEEVE



| | | | | | | | | | | | | |
|-------|-------|-----|-------|----|-------|-----|-------|-----|-------|-----|-------|-----|
| #6 | 2903A | 500 | 2903C | 25 | 3003A | 500 | 3003C | 25 | 3103A | 250 | 3103C | 20 |
| #8 | 2904A | 500 | 2904C | 25 | 3004A | 500 | 3004G | 100 | 3104A | 250 | 3104G | 100 |
| #8 | — | — | — | — | — | — | 3004C | 25 | — | — | 3104C | 20 |
| #10 | 2905A | 500 | 2905C | 25 | 3005A | 500 | 3005G | 100 | 3105A | 250 | 3105G | 100 |
| #10 | — | — | — | — | — | — | 3005C | 25 | — | — | 3105C | 20 |
| 1/4" | 2906A | 500 | 2906C | 20 | 3006A | 500 | 3006G | 100 | 3106A | 250 | 3106G | 100 |
| 1/4" | — | — | — | — | — | — | 3006C | 20 | — | — | 3106C | 18 |
| 5/16" | 2908A | 500 | 2908C | 20 | 3008A | 500 | 3008G | 100 | 3108A | 250 | 3108G | 100 |
| 5/16" | — | — | — | — | — | — | 3008C | 20 | — | — | 3108C | 18 |
| 3/8" | 2909A | 500 | 2909C | 20 | 3009A | 500 | 3009G | 100 | 3109A | 250 | 3109G | 100 |
| 3/8" | — | — | — | — | — | — | 3009C | 20 | — | — | 3109C | 18 |

All Items with QT, KT, GT or PT Suffix are Clam Shell Program Items.